

**Sales - Plot - La Cala Golf**

**1.500.000€**

**www.arbatestates.com**

**+34 606 84 36 45**

**+34 602 51 80 97**

**info@arbatestates.com**

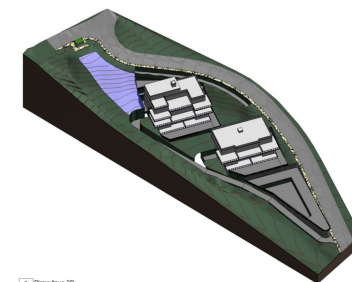

3D Plano Nivel 3D

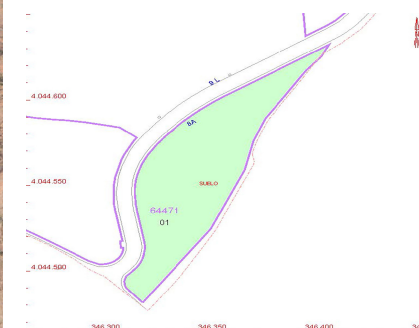

**Ref.-ID: R3848254**

**La Cala Golf**

**Plot**



**1704 m2**



**4446 m2**

Investment plot of 4.446m<sup>2</sup> with buildable 1.704,06m<sup>2</sup> and maximum of 20 units. Residential Plot, La Mairena, Costa del Sol. Garden/Plot 4446 m<sup>2</sup>. Setting : Suburban, Country, Mountain Pueblo, Close To Golf, Close To Sea, Close To Town, Close To Schools, Urbanisation. Orientation : East, South, South West. Condition : New Construction. Views : Sea, Mountain, Panoramic. Utilities : Electricity, Drinkable Water.

**Setting**

- ✓ Suburban
- ✓ Close To Golf
- ✓ Close To Town
- ✓ Urbanisation

**Orientation**

- ✓ East
- ✓ South
- ✓ South West

**Condition**

- ✓ New Construction

**Views**

- ✓ Sea
- ✓ Mountain
- ✓ Panoramic

**Utilities**

- ✓ Electricity
- ✓ Drinkable Water